

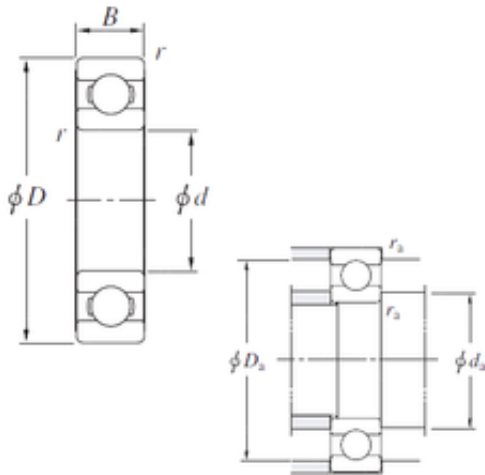

BEARING-SINGAPORE (PTE)LTD.



16038 KOYO Single-row deep groove ball bearings

Bearing No. 16038

16038 Bearing 2D drawings and 3D CAD models

| | |
|-------------------------------|---------------|
| Size | 190x290x31 mm |
| Bore Diameter | 190 mm |
| Outer Diameter | 290 mm |
| Width | 31 mm |
| d | 190 mm |
| D | 290 mm |
| B | 31 mm |
| C | 31 mm |
| r min. | 2 mm |
| da min. | 199 mm |
| Da max. | 281 mm |
| ra max. | 2 mm |
| Weight | 7,85 Kg |
| Basic dynamic load rating (C) | 139 kN |
| Basic static load rating (C0) | 158 kN |
| (Grease) Lubrication Speed | 2000 r/min |
| (Oil) Lubrication Speed | 2400 r/min |
| Bearing No. | 16038 |
| r(min) | 2 |
| Cr | 173 |
| C0r | 158 |
| Cu | 5.20 |
| f0 | 16.6 |
| Grease lub. | 2000 |
| Oil lub. | 2400 |



BEARING-SINGAPORE (PTE)LTD.

| | |
|------------------|------|
| da(min) | 199 |
| Da(max) | 281 |
| ra(max) | 2 |
| (Refer.)Mass(kg) | 7.85 |