

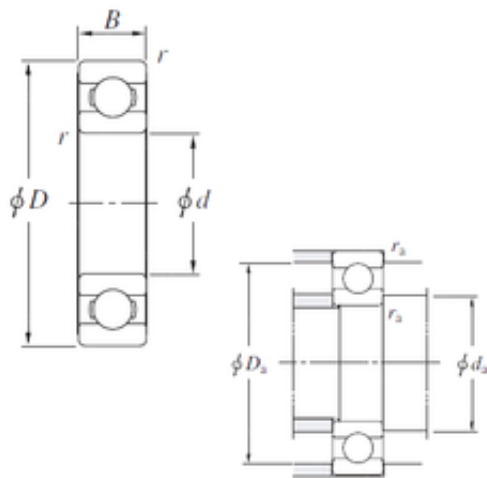

BEARING-SINGAPORE (PTE)LTD.



6336 KOYO Single-row deep groove ball bearings

Bearing No. 6336

6336 Bearing 2D drawings and 3D CAD models

Size	180x380x75 mm
Bore Diameter	180 mm
Outer Diameter	380 mm
Width	75 mm
d	180 mm
D	380 mm
B	75 mm
C	75 mm
r min.	4 mm
da min.	196 mm
Da max.	364 mm
ra max.	3 mm
Weight	44,7 Kg
Basic dynamic load rating (C)	354 kN
Basic static load rating (C0)	407 kN
(Grease) Lubrication Speed	1600 r/min
(Oil) Lubrication Speed	1900 r/min
Bearing No.	6336
r(min)	4
Cr	443
C0r	407
Cu	22.1
f0	13.9
Grease lub.	1600
Oil lub.	1900



BEARING-SINGAPORE (PTE)LTD.

da(min)	196
Da(max)	364
ra(max)	3
(Refer.)Mass(kg)	44.7